

THE ULTIMATE GUIDE TO MOD PODGE[®]

LEARN THE ART OF DECOUPAGE



INTRODUCTION

Looking for a new art form to expand your crafting arena? Are you a passionate paper crafter looking for a way to express your creativity? Have you ever wondered what Mod Podge is all about? Want to learn more?

“The Ultimate Guide to Mod Podge” serves as a comprehensive resource for learning about Mod Podge, the formulas, and each formula’s unique features. You will also see the variety of sheens once each formula is applied to a surface and is dry.

You will also learn about the variety of Mod Podge applicators and tools. Learning when and how to use each tool will make your decoupage experience exciting and easy.

Additionally you will find various accessory products including Mod Podge Stiffy, Mod Podge Collage Clay, Mod Podge Dimensional Magic and the Mod Melter in this Mod Podge eBook. These products can be used alone or combined with other Mod Podge products on any decoupage project.

Complete step-by-step instructions with clear, easy-to-follow photos will provide you with the basics to begin your Mod Podging experiences. Basically, this is the best resource eBook for all things Mod Podge! Now let’s jump into the exciting world of Mod Podge!

TABLE OF CONTENTS

- HISTORY OF MOD PODGE 3
- MOD PODGE FORMULA GUIDE..... 4-8
- MOD PODGE TOPCOAT FINISHES 9
- MOD PODGE SPECIALTY PRODUCTS 10-12
- MOD PODGE PERFECT ENDINGS13
- MOD PODGE TOOL GUIDE 14-16
- MOD PODGE SURFACES.....17
- BASICS OF MOD PODGE SURFACE PREP.....18
- MISCELLANEOUS SUPPLY LIST.....18
- BASICS OF DECOUPAGING WITH MOD PODGE.....19-20
- MOD PODGE FORMULA GUIDE CHART21
- MOD PODGE SOCIAL MEDIA / CREDITS..... 22



HISTORY OF MOD PODGE

What is Mod Podge? Mod Podge is a craft medium that was created approximately 50 years ago to meet the demands of the ever-popular crafting trend - decoupage.

What is decoupage? Decoupage: a French word, meaning to cut out, is referred to as the art of cutting out paper images, adhering them to a surface and then brushing over with multiple layers of varnish or lacquer. Fifty plus years ago, this was a tedious, time-consuming, and messy craft, as each layer of solvent-based varnish, needed proper ventilation and dry time. Decoupage artists would also sand between layers to keep the surface even and smooth.

In 1967, to “modernize” labor-intensive decoupage techniques, Jan Wetstone, an Atlanta native, created the first water-based decoupage medium, and Mod Podge was born! As a water-based product, it could be used as a glue, a sealer and a varnish, making it perfect for modern day decoupage techniques. Using water-based Mod Podge in place of solvent-based varnishes, sped up the dry times and the decoupage technique process allowing artisans the ability to create more pieces in less time! The first two Mod Podge formulas developed were Gloss and Matte. Mod Podge, itself, is short for “modern decoupage.”

Plaid Enterprises purchased Mod Podge in 1979 and the rest is history! Since the initial purchase of Gloss and Matte, Plaid has developed the product line to several exciting, easy-to-use formulas, a variety of applicators and tools as well as accessory products; all shown in this eBook. So let’s get started now to learn about these products and when to use them!



One of Jan's most famous Mod Podge projects - her fabric-covered VW Bug.

MOD PODGE FORMULA GUIDE



GLOSS

One of the two Mod Podge original formulas created, Gloss, is a classic enjoyed by many. When applied to a surface the finish offers a definitive, shiny effect.



MATTE

Another example of the original two Mod Podge formulas, Matte is a staple, “go-to” finish. Matte Mod Podge provides a simple, yet basic non-shiny finish.



SATIN

As the third Mod Podge formula to be created, Satin, falls somewhere between the first two finishes, as it is not matte nor is it shiny. This formula provides a soft-to-the-touch subtle, satin finish to decoupage projects.



ULTRA MATTE CHALK

Brushes on without visible brush marks, Ultra Matte Chalk Mod Podge was created with today’s chalk painted projects in mind. The beautiful, smooth finish matches that of soft, ultra matte chalk painted finishes. This makes decouping on a chalk painted surface a breeze, as there is no sheen difference between the chalk base color and decoupage design!

MOD PODGE FORMULA GUIDE



SPARKLE

Containing two different sizes of holographic glitter, Mod Podge Sparkle is the formula to use when a decoupage project needs that extra touch of glitz and glimmer. It is perfect for holiday projects as well as fashion accessories or jewelry because it dries to a sparkly gloss sheen.



EXTREME GLITTER

Decoupage projects requiring that “extra” glitter and shimmer should incorporate Mod Podge Extreme Glitter as it contains three different sizes of holographic glitter particles. It dries to a glossy, glittery finish making it perfect for everyday projects needing that glamorous touch or handmade decorations for special holidays.



OUTDOOR

Everyone loves the outdoors, including this formula of Mod Podge. Perfect for outdoor decorations and patio living, Mod Podge Outdoor safely seals a variety of outdoor surfaces with a gloss sheen, such as: wood birdhouses, terra cotta flower pots, metal garden signs, and more.



WASH-OUT FOR KIDS

Love crafting with the kids, but hate the mess. Mod Podge Wash-Out for Kids is the perfect formula to use when crafting with children. No worries about spillage or getting it on their clothes as it easily washes out from fabrics, even after it dries - no need to presoak! Both parents and teachers alike, LOVE this formula!

MOD PODGE FORMULA GUIDE



HARD COAT

The best formula for heavily-used functional pieces, Mod Podge Hard Coat adds extra durability while providing added protection to a decoupaged surface. It's perfect for well-loved and well-used project surfaces as it provides confidence in its sustainability and it dries to a gorgeous satin finish.



FABRIC

Developed for its use to adhere fabric to fabric, this Mod Podge formula provides a tight bond between fabrics while still being washable. Once applied to the backside of fabric and allowed to thoroughly dry, it also can be used to prevent frayed fabric edges when cutting applique designs. If applied to the topside of fabrics, Mod Podge Fabric will dry to a gloss finish.



PAPER - MATTE & GLOSS

Perfect to use when creating paper-to-paper decoupage projects, such as notecards and scrapbook layouts, this Mod Podge formula provides archival qualities as it is non-yellowing and acid free. Paper Mod Podge is available in both Matte and Gloss finishes. Brushed on with a light application, this formula will dry with a smooth finish as it helps to eliminate wrinkles between the layers of paper.



DISHWASHER-SAFE

When using Mod Podge Dishwasher-Safe, decorative glassware, ceramics and porcelains can now be permanently embellished with decoupage and still be washable! Once properly applied and cured to the surface, projects can either be hand washed or are top shelf dishwasher safe. Like glassware, Mod Podge Dishwasher-Safe dries to a gloss sheen.

MOD PODGE FORMULA GUIDE



ANTIQUe MATTE

Want to add an aged, vintage style to a decoupage project? Mod Podge Antique Matte is the perfect formula for this effect as it adds a slight amber, non-shiny, aged look to the decoupage surface.



GLOW-IN-THE-DARK

Want to create a fun “glow” over your decoupage project? Mod Podge Glow-In-The-Dark is the one to use. Brushing on multiple coats and “charging” the finish in sunlight or under lamps will create that fun glow-in-the-dark effect perfect for Halloween crafting or night-time events where a little extra glow is required! Once dried and cured, Mod Podge Glow-In-The-Dark has a gloss finish.



PEARL

Looking for a Mod Podge formula that will create a pearlescent effect? You found it, with Mod Podge Pearl! Like most Mod Podge formulas, Pearl can be used as a glue as well as sealer. It is perfect for holiday projects needing that extra touch of pearl with a gloss sheen.



MOD PODGE FORMULA GUIDE

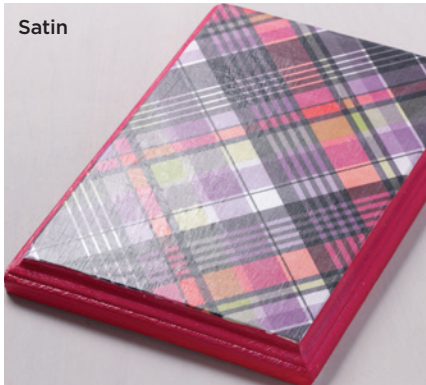

Project instructions can be found: <https://www.plaidonline.com/mod-podge-repurposed-shelf/5655/project.htm>

FURNITURE - MATTE, SATIN, & GLOSS

Refurbish an old piece of furniture into a work of decoupaged art! Mod Podge Furniture, available in three sheens: Matte, Satin and Gloss, is the formula for you! When dry, it provides a super durable, long-lasting, tough finish; making it the best formula for heavily-used surfaces such as tables, chairs, bookshelves, etc.

MOD PODGE TOPCOAT FINISHES

Unlike most Mod Podge formulas that are created to serve as a glue, sealer and finish, these three Mod Podge products are topcoat finishes only, not to be used as a glue. Choose to use a basic formula like Matte, Satin or Gloss to decoupage, then use one of these topcoat finishes to achieve the desired effect.

TIPS:

- Be sure to allow the decoupage surface ample dry time prior to applying the Mod Podge Topcoat of choice. If a second application is desired, allow the first topcoat application to thoroughly dry prior to brushing on the second.
- Mod Podge Topcoats are best brushed onto a project surface using a soft, Taklon bristle brush which will help eliminate brush stroke marks.



CLEAR CHALKBOARD TOPCOAT

Clear Chalkboard Topcoat enables you to turn any paper decoupage surface or any painted surface into a chalkboard surface. Following simple instructions, an even topcoat is applied and then allowed to dry to a matte finish. Before writing a chalk message, condition the surface by chalking over the entire chalkboard area, then wipe it clean.

- **TIP:** If a painted chalkboard surface is not conditioned, there will forever be a “halo” of the first chalk message.



BRUSHSTROKE - MATTE & GLOSS

Create drama and dimensional texture with this formula of Mod Podge. When applied to posters or printed artwork, Mod Podge Brushstroke Gloss provides a shiny, dimensional effect that could be achieved from an artist’s brush with paint. First, decoupage artwork to a canvas, then apply Mod Podge Brushstroke to create the “real” artistic effect. If using Mod Podge Brushstroke Matte the completed surface will dry to a flat, non-shiny finish.

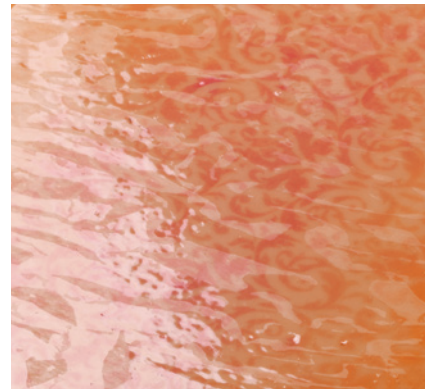

SUPER GLOSS TOPCOAT

Not to be confused with other formulas, Mod Podge Super Gloss is formulated as a finish or topcoat only. Once a surface has been decoupage and is dry, an application of Mod Podge Super Gloss will raise the “gloss factor” creating a super shiny, glossy finish perfect for modern-styled effects.

- **TIP:** To apply Mod Podge Super Gloss to a dry decoupage surface, pour a small amount of topcoat over the surface. Using a soft, gold Taklon brush, gently brush the topcoat in one direction, smoothing it over the surface. Immediately, while still wet, brush over the surface in the opposite direction. Do NOT overwork as Mod Podge Super Gloss is self-leveling. This topcoat will cure in four weeks.

MOD PODGE SPECIALTY PRODUCTS

To complete the Mod Podge family, the following products were developed as accessories to the line allowing the general crafter to further embellish and stretch their creativity.



DIMENSIONAL MAGIC

Adding a clear, glossy, dramatic, dimensional embellishment to a decoupage surface has never been easier. Perfect for jewelry, scrapbooking, card making and embedding small trinkets. Mod Podge Dimensional Magic with its “stay put” formula, adds an epoxy-like accent and texture to any decoupage project.

Mod Podge Dimensional Magic is available in three finishes: Clear, Sepia and Glitter Gold.

In photo above, Mod Podge Dimensional Magic was added to all three feathers and each turquoise diamond shaped center.

HELPFUL HOW-TO:

- Remove cap and invert bottle over project.
- Direct nozzle where dimensional accents are desired.
- Lightly squeeze bottle while moving nozzle across surface. Mod Podge Dimensional Magic will “stay put” and not flow outside of desired lines.
- Keep project surface flat and allow to thoroughly dry overnight.
- **TIP:** Small beads, sequins, or trinkets can be embedded in wet Dimensional Magic.
- **TIP:** Mod Podge Dimensional Magic can also be used when creating layers of dimensional effects. Be sure to dry thoroughly between layers.

STIFFY

Not to be confused with a decoupage medium, Mod Podge Stiffy is a fabric stiffener that can transform limp fabrics, ribbons, lace, doilies and needlework into stiffened shapes drying to a matte finish. Crocheted doilies and lace can easily become decorator bowls and stiffened ribbon can add a unique border trim to any project!

HELPFUL HOW-TO:

- Pour a small amount of Stiffy into a bowl or container. Saturate crocheted doily or fabric with Stiffy.
- Squeeze, removing excess Stiffy. Pour remaining Stiffy back into jar.
- Drape saturated doily over prepared form and allow to dry.
- **TIP:** To prepare form, cover an inverted bowl with non-cling plastic wrap; place the inverted bowl over a jar or container elevating it to desired height.
- **TIP:** Be sure to protect work surface with additional sheets of plastic wrap as excess Stiffy will drip from the saturated doily once placed on the prepared form.
- Once dry, remove doily from form and discard plastic wrap.
- **TIP:** If desired, embellish the stiffened doily by weaving ribbon through the crocheted doily openings.
- **TIP:** Mod Podge Stiffy can be tinted with acrylic paint before stiffening doilies.

MOD PODGE SPECIALTY PRODUCTS

PHOTO TRANSFER MEDIUM

Transferring a photocopy image to a surface such as wood, fabric, canvas, tin and more has never been more fun when using easy-to-apply Mod Podge Photo Transfer Medium.



Direct to Surface Technique

HELPFUL HOW-TO:

- Create a photocopy of an original photograph, graphic design, phrase or image using a laser printer or copier onto regular printer paper. **IMPORTANT:** Each photocopy should be created from a dry toner base copier not an ink-jet copier.
- **TIP:** When creating photocopies of the original photo or print, be sure to create a reverse image if names, numbers or text appear in the original image.
- Trim photocopied image to desired size.
- Simply brush a generous application of transfer medium onto the face of photo copy image; be sure to cover the entire image.
- Flip the image over and position it onto the project surface, transfer side down.
- Smooth image from the center outwards removing air pockets. Allow to dry 24 hours.
- Moisten exposed paper with water-dampened sponge. Begin rubbing in a circular motion to remove layers of paper revealing the transferred image.
- **TIP:** When removing the layers of paper to expose the transferred image, it is best to work in stages by removing paper while it is wet; allow it to dry, then repeat wetting the paper and removing a layer. It is possible to work too fast and rub too hard, removing too many layers of paper at one time which can possibly damage the transferred image. A completed transferred image will no longer have a white haze over it when dry.
- **TIP:** Completed photo transfers can be sealed with an application of the Mod Podge, formula of choice, which may remove any remaining white haze.
- **TIP:** Mod Podge Photo Transfer Medium is glossy, however, once an image has been transferred, the image will be matte until a topcoat is applied because the exposed transferred copy paper is matte.
- **TIP:** A Mod Podge photo transferred image on fabric is also machine washable.



Decal Photo Transfer Technique

Perfect for any smooth, non-porous surface like glass and glazed ceramics.

HELPFUL HOW-TO:

- Photocopy or print image to be transferred, using a laser printer onto regular printer paper.
- Trim photocopied image to desired size.
- Apply thick layer of Mod Podge Photo Transfer Medium to the image side of photocopy so that it's completely covered.
- **TIP:** Either a gold Taklon bristle brush or a foam applicator can be used to apply Mod Podge Photo Transfer Medium.
- Place face up on a piece of wax paper or a non-stick craft mat and allow to completely dry for 24 hours.
- When dry, flip the image over onto a clean section of wax paper and apply a wet sponge to the backside of the image, moistening the paper.
- Begin to rub over wet paper lightly using a circular motion. The excess paper should dissolve away from the backside of the treated image. Allow to dry.
- Once dry, a white haze may form where some of the paper still remains. Repeat the wetting process until all the paper residue is gone.
- The image is now a decal and can carefully be peeled up from wax paper or craft mat.
- Apply to glass surface image side up. The image decal will cling to the glass.
- **TIP:** The Decal Method of transferring images is the perfect transfer method for seasonal glassware displays.



MOD PODGE SPECIALTY PRODUCTS



PUZZLE SAVER

After spending hours assembling a puzzle of thousands of pieces, ever wish you could keep it assembled and display your creation? Well now you can, with Mod Podge Puzzle Saver, a brush-on glue and sealer that will secure the completed puzzle which then can be mounted for display. Mod Podge Puzzle Saver dries to a shiny, gloss finish.

HELPFUL HOW-TO:

- Place completed puzzle face up on non-cling plastic wrap.
- Apply Puzzle Saver evenly over entire puzzle including cracks; let dry completely, approximately 15-20 minutes.
- **TIP:** To ensure complete coverage including cracks, drizzle or pour Mod Podge Puzzle Saver over the front of the completed puzzle. Squeegee the Puzzle Saver over the surface using a Mod Podge Squeegee filling all cracks. Allow to dry.
- Place dry puzzle face down on clean, non-cling plastic wrap.
- Repeat by applying Puzzle Saver to backside of puzzle; let dry completely.
- **TIP:** Additional coats can be applied for added protection.
- **TIP:** Once completely dry and cured, spray seal with Mod Podge Clear Acrylic Sealer to remove stickiness.



COLLAGE CLAY

A whipped lightweight, faux icing clay, packaged in a piping bag along with three different decorator tips and a storage cap, is available in Vanilla White and Strawberry Pink.



Mod Podge Collage Clay, is versatile and can be used many ways.

- The faux clay is pliable when wet so that small trinkets and gems can be embedded, yet it is sturdy enough to suspend the embellishments while creating Decoden effects.
- Mod Podge Collage Clay can also be palette knifed through a stencil creating decorative raised textures on surfaces.
- When dry, it can be painted, glazed or distressed.
- Perfect for holiday crafting, this versatile product can also be used to create snow effects.
- **TIP:** Mod Podge Collage Clay can be tinted any shade using acrylic paint like FolkArt Acrylics.

MOD PODGE PERFECT ENDINGS

Protect all decoupage creations with a dust and fingerprint-resistant spray finish. Mod Podge Clear Acrylic Sealers can be used over water-based and oil-based paints, glazes, lacquers and varnishes. They dry clear, are waterproof, and non-yellowing. Choose from four classic looks: Matte - for an original subtle finish, Gloss - for a basic shiny finish, Hi-Shine for an extra glossy finish and Pearl for a lustrous pearlized finish perfect for weddings and holidays.



MATTE ACRYLIC SEALER



GLOSS ACRYLIC SEALER



SUPER HI-SHINE ACRYLIC SEALER



PEARLIZED GLAZE ACRYLIC SEALER



MOD PODGE TOOL GUIDE



2 1/4" BRUSH APPLICATOR

With its rounded corners similar to a filbert brush, this Mod Podge gold Taklon 2 1/4" flat brush is perfect for smaller projects. It fits comfortably in the palm of the hand and provides a smooth Mod Podge application leaving fewer brush marks.



4" BRUSH APPLICATOR

The Mod Podge Brush applicator is definitely a one-on-a-kind tool with its short handle and chisel edged, gold Taklon bristles. This is the perfect tool to use on a variety of large surfaces such as large canvases. The gold Taklon bristles help guide Mod Podge over the surface without a trail of visible brush marks. It is a durable tool with a steel ferrule that can be cleaned and reused many times.



FURNITURE DECOUPAGE BRUSH SET

If decoupage a large piece of furniture is on your list, try using this brush set. The Mod Podge Furniture Decoupage Brush Set is sized right for larger surfaces and the longer handles make gripping the brush easy. Each brush is made with gold Taklon bristles which assist in creating a smooth, even application of Mod Podge with less brush marks. This brush set includes a 2" and a 3" wide flat brush.



DECOUPAGE BRUSH SET

This set of Mod Podge flat brushes are different from other sets because the gold Taklon bristles are much shorter. The shorter, stubbier bristles are perfect when working on an ornately designed dimensional surface because they help to press papers into tight creases. This brush set contains: 1 1/4", 1 1/16" and 3/8" flat brushes.



DETAIL BRUSH SET

When working on very small jewelry projects or adding a touch of detail to a completed project, a brush from the Mod Podge Detail Brush Set would be the one to choose. This ten-piece, gold Taklon bristle brush set includes: Spotter 10/0; Liner 10/0, 1; Round 10/0, 0, 1, 3, 5; and Flat 2, 4.



FOAM BRUSH SET

Sometimes called sponge brushes, the Mod Podge Foam Brush Set is often used as the applicator of choice when decoupage. These foam brushes can be cleaned immediately after each use; simply rinse under running water. They can then be reused over and over. The four-piece Foam Brush Set is packaged with one each: 1/2", 3/4", 1" and 1 1/2" brushes making it the perfect applicator set for just about any sized project.

MOD PODGE TOOL GUIDE



ROLLER APPLICATOR

Large, smooth, flat surfaces are perfect for the Mod Podge Roller Applicator. Simply fill the 2 oz. bottle with the Mod Podge formula of choice, attach a roller top then invert the bottle and roll with it! This handy tool can be used to both apply paper to the surface as well as to topcoat or seal the finish over the decoupage surface. Immediately clean the foam roller after each use.



PROFESSIONAL DECOUPAGE TOOLS

This two-piece set, a Mod Podge Squeegee and a Mod Podge Brayer are essentials that every modern-day decoupage artist should have! Both used as smoothing tools, the Squeegee and Brayer will smooth the paper being decoupage onto a surface removing air pockets and wrinkles as well as excess Mod Podge.

TIP: It is always best to smooth from the center of the decoupage image moving towards the surface edge.



SPOUNCER SET

This set of four small Mod Podge Spouncers are perfect for applying Mod Podge to small projects. When embellishing a decoupage project, they can also be used with paint to create painted polka dots or to apply paint through a stencil. Clean up is easy with soap and water.



TOOL KIT

This set is a must have! All decoupage basic tools are grouped together in one place and then stored in a handy-to-keep zippered pouch! Supplies included in the kit: Mod Podge Squeegee, 6" ruler, Mod Podge 3/4" flat gold Taklon bristle brush, 3 1/2" and 6 1/2" scissors and a Mod Podge emery board used for distressing techniques.



DECOUPAGE TRACING TEMPLATES

A wonderful creative tool to have on hand are the Mod Podge Decoupage Tracing Templates! These heavy cardstock paper cut-out template shapes can easily be traced on fabric or paper. Then cut out the traced designs to be creatively used on a decoupage project. Included in the package are 26 sheets of alphabets, pennants and some basic shapes. The heavy cardstock paper template is durable and can be reused many times.



MOD PODGE TOOL GUIDE



MOD MELTER

The Mod Podge Mod Melter is a very uniquely-shaped tool. It can be used as a high temp glue gun or it will easily melt Mod Melts to be dispensed into Mod Molds creating dimensional embellishments. The sleek design of the Mod Melter allows crafters the ability to hold the tool vertically upright directly over the project surface with a full line of sight. Conveniently constructed with a built-in stand, an on/off switch, a 6 ft. long electrical cord, and easy-to-use large control trigger, silicone covered tip and a silicone soft grip, the Mod Melter is the tool no craft room should be without.



MOD MOLDS & MOD MELTS

Mod Podge Mod Molds are durable silicone molds shaped into a variety of designs and are used in combination with Mod Podge Mod Melts and the Mod Melter.

Simply insert a Mod Melt into the Mod Melter, plug it in and turn it on to heat it up. Then squeeze the Mod Melter trigger while directing melted Mod Melt into the Mod Mold of choice.

Allow the Mod Melt to completely cool approximately seven minutes, then easily pop out the dimensional embellishment.

These easy-to-create embellishments can be painted or left natural to be used as the finishing touch on any craft project.

There are fifteen different Mod Molds and six different color package options available of Mod Melts:

- Glitters
- Metallics
- Opaque colors
- Neon colors
- Sea glass clear
- Milk glass white



SILICONE CRAFT MAT

The Mod Podge Silicone Craft Mat is the perfect work surface as it will protect your work area from paint or Mod Podge, making clean up a breeze. Simply clean the Silicone Craft Mat with soap and water after each use. It is also heat resistant up to 600 degrees Fahrenheit and can be used as a landing pad for the Mod Melter. The translucent white mat is easy to see thru when a pattern is placed under it, making doodling with Mod Melts a snap!



SILICONE TOOL SET

A perfect companion tool set to the Silicone Craft Mat, the three piece Silicone Tools Set includes a wand, a paddle and a silicone-tipped pair of tweezers. All three tools are great for pressing small objects into hot glue. The silicone tips all clean up easily with soap and water.



HOT GLUE FINGERCAPS

Protecting your fingertips is essential when working with hot glue. Mod Podge Hot Glue Finger Caps will protect you while pressing objects into hot glue; NO more burns! The silicone will withstand temperatures up to 600 degrees! This set contains three finger caps, two large and one medium-sized.

MOD PODGE SURFACES

The following Mod Podge surfaces can be used to create exceptional decoupage jewelry, wonderful dimensional embellishments or mixed media adornments. These Mod Podge surfaces are fun to use on just about any craft project!



PODGEABLE SHAPES - BASICS

Mod Podge Podgeable Shapes are perfect when creating jewelry, altered art, mixed media, scrapbooking or any other craft that needs a special embellishment.

Eighteen polystyrene shapes available in circles, ovals, rectangles or squares with pre-drilled holds can be decoupage on one side or both to create one-of-a-kind decoupage embellishments.



PODGEABLE GLASS DOMES

This package of Mod Podge Glass Dome surfaces contain six pieces which can be used on a variety of decoupage projects where a little extra dimension is needed.

Shapes included are: circles, ovals and rectangles.



PODGEABLE METAL BLANKS

Mod Podge Podgeable Metal Blanks available in small, medium and large sizes - made of ox brass, rhodium and ox copper are perfect for jewelry crafting!

In one convenient package, there are ten Podgeable Metal Blanks including round, oval, rectangle, and square shapes and two ring blanks.

TIP: Try combining basic decoupage techniques collaging tiny paper designs and then apply Mod Podge Dimensional Magic to seal the collaged design in an epoxy-like finish!

In addition to these Mod Podge surfaces, other surfaces such as wood, metal/tin, canvas, fabric, paper mache, terra cotta, glass/ceramics and even rigid plastic make wonderful decoupage project surfaces!

The key is knowing how to properly prepare the variety of surfaces to ensure a professional finish once the decoupage project is completed.



SURFACE PREP / MISCELLANEOUS SUPPLIES

BASICS OF MOD PODGE SURFACE PREP

Understanding the different Mod Podge formulas, tools and surfaces available is great, now let's learn how to decoupage.

Creating a decoupage project is not only fun, it can be super simple. Begin by preparing your desired surface correctly. The main concern is to have all surfaces thoroughly cleaned prior to decoupage to promote better adhesion and to ensure a smooth finish when the project is completed.

- **Wood** - If desired, sand smooth any rough areas. Raw wood can be stained, basecoated using acrylic paints or even left natural. If treated with paints or stains, be sure to allow ample dry time prior to decoupage.
- **Terra Cotta** - Wipe to remove dust. If the terra cotta flower pot has been previously used, be sure to thoroughly clean in warm soapy water to remove all dirt deposits and allow to dry completely. If the terra cotta flower pot will be used with a live plant, seal interior prior to planting so water does not seep through possibly blistering the exterior. As an option, terra cotta may also be basecoated with an acrylic paint prior to decoupage papers or fabrics.
- **Metal and Tinware** - Metal that has been enameled or sealed should be washed in warm soapy water, dried and then wiped with white distilled vinegar to remove remaining grease or soap residue.
- **Canvas** - No prep required prior to decoupage on canvas except to wipe it free of dust.
- **Rigid Plastic** - Wash the surface well in warm soapy water, rinse and thoroughly dry. Wipe over surface with rubbing alcohol prior to decoupage on rigid plastic which will remove remaining grease or soap residue as well as static.
- **Paper Mache** - Wipe over surface with a dry paper towel to remove dust.
- **Fabric** - Prewash all washable fabrics and allow to dry prior to using in a decoupage project.
- **Glass and Ceramics** - Wash surface well in warm soapy water, rinse and allow to dry thoroughly. Wipe over surface with rubbing alcohol to remove remaining soap or grease residue.

MISCELLANEOUS SUPPLIES

In addition to the project surface and desired scrap-book papers to be decoupage, the chosen Mod Podge formula and necessary tools, every Mod Podge project may also require an assortment of the following miscellaneous supplies.

- Mod Podge Squeegee
- Mod Podge Brayer
- Mod Podge Silicone Craft Mat
- Mod Podge Brushes, either foam applicators or gold Taklon bristle brushes
- Palette or foam plates and bowls
- Waxed paper
- Sandpaper
- Brush Basin or container for water
- Scissors
- Paper towels
- Ruler or yardstick
- Pencil
- Craft knife
- Self healing cutting mat



BASICS OF DECOUPAGING WITH MOD PODGE

Taking the mystery out of decoupage is easy when creating with Mod Podge products. And although there are many different formulas offering different sheens that can be used on a variety of surfaces, the basics of “Mod Podging” is the same. Let’s take a look at just how easy it is to Mod Podge a surface.

- A** Gather all necessary supplies.
 - B** Begin by preparing the scrapbook paper to fit the project surface. Either measure with a ruler and mark the shape using a pencil on the desired scrapbook paper, or press along the edges of the surface creating a crease in the paper.
 - C** Carefully trim the patterned paper, using Mod Podge scissors, to the desired shape. If using paper appliques, carefully trim around the applique design.
 - D** Using a color of acrylic paint that coordinates with the paper design, and a Mod Podge foam applicator apply a smooth, even basecoat to the project surface. Allow to dry.
 - E** Apply an even coat of Mod Podge formula of choice onto both the backside of the pre-cut paper as well as the front side of the project surface using a Mod Podge gold Taklon bristle brush.
- TIP:** Mod Podge Foam Applicator can also be used, however, fewer brush marks will be created when using light pressure and a Taklon bristle brush.

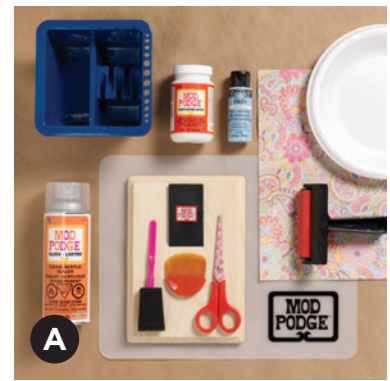

BASICS OF DECOUAGING WITH MOD PODGE

- F** Carefully, flip the decoupage paper over and position it onto the project surface matching the edges.

TIP: It is best to position “glue to glue” when decoupage as this will ensure the stability of the paper to the surface. It may also provide a moment or two to move the paper into the correct space before it takes hold.

- G** Smooth paper in place using clean hands, a Mod Podge Squeegee or a Mod Podge Brayer. Allow to dry 15–20 minutes.

TIP: When smoothing the paper on the project surface, smooth from the center outwards. If excess Mod Podge is squeezed out, quickly wipe to remove the excess using a damp paper towel.

TIP: Many crafters also find it easier to work with a sheet of clean waxed paper between the decoupage paper and the smoothing tool. The squeegee or brayers will easily glide over the waxed paper making it easier to smooth into place. It may also capture the excess Mod Podge squeezed onto the image edges. Carefully lift to remove the wax paper while still wet. Allow decoupage image 15–20 minutes to dry.

- H** After 20 minutes, brush on a topcoat of desired Mod Podge formula to seal and protect the decoupage design. Allow to dry.

TIP: Dry times may vary depending on the thickness of the Mod Podge applications, humidity and air flow. Be patient and allow the decoupage area to thoroughly dry before applying additional topcoats.

- I** Once the decoupage surface is dried and cured, if stickiness remains due to humidity, lightly spray seal the Mod Podged surface using a Mod Podge Spray Clear Acrylic Sealer (formula of choice.)

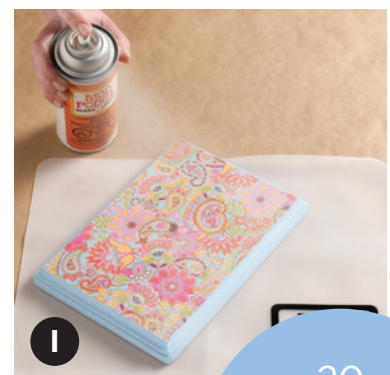
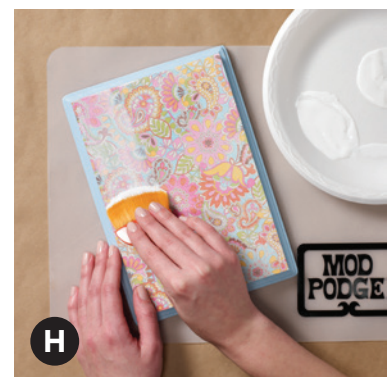

MOD PODGE FORMULA GUIDE CHART

WHICH MOD PODGE SHOULD I USE?

Wood, paper, fabric, glittery, shiny, subtle - WOW! There are so many Mod Podge decoupage possibilities - try them all!

Antique Matte	●	●	●	●		●	●	●	●	●	●	●	●	●	●	●	
Brushstroke Matte & Gloss		●								●	●			●	●		
Classic Matte, Gloss & Satin	●	●	●	●		●	●	●	●	●	●	●	●	●	●	●	
Clear Chalkboard Topcoat		●	●	●		●	●		●	●	●	●	●	●		●	
Dimensional Magic	●	●		●		●	●		●	●	●	●	●	●	●	●	
Dishwasher-Safe			●				●			●							
Extreme Glitter	●	●	●	●		●	●	●	●	●	●	●	●	●	●	●	
Fabric	●	●		●	●	●		●	●							●	
Furniture Matte, Gloss & Satin	●	●	●	●		●	●	●	●	●			●	●		●	
Glow-in-the-Dark	●	●	●	●		●	●	●	●	●	●	●	●	●	●	●	
Hard Coat	●	●	●	●		●	●	●	●	●	●	●	●	●	●	●	
Outdoor	●	●	●	●		●	●	●	●	●		●	●	●	●	●	
Paper Matte & Gloss	●	●	●	●		●	●	●	●	●	●	●	●	●	●	●	
Pearl	●	●	●	●		●	●	●	●	●	●	●	●	●	●	●	
Photo Transfer		●	●	●		●	●		●	●	●		●			●	
Puzzle Saver															●		
Sparkle	●	●	●	●		●	●	●	●	●	●	●	●	●	●	●	
Stiffy Fabric Stiffener				●				●	●								
Super Gloss Topcoat	●	●	●	●			●	●	●	●	●	●	●	●	●	●	
Ultra Matte Chalk	●	●	●	●		●		●	●	●	●	●	●	●	●	●	
Wash-Out For Kids		●				●				●	●	●			●	●	
		beads, gems	canvas	ceramics	fabrics, cotton	felt	foam	glass	lace trim	leather, suede	metal, tin	paper	paper mache	plaster	plastic, vinyl	puzzles	wood

SOCIAL MEDIA / CREATIVE CREDITS

CONNECT WITH PLAID'S SOCIAL CHANNELS

Every day, Plaid reaches tens of thousands of crafters, makers and DIY enthusiasts through all our social media channels.

While visiting Plaid's social channels, you will find creative, innovative projects that will inspire you. These projects will instill in you the desire to join in the fun, by recreating one of these projects or perhaps by creating an original one of your own!

You can also join in our daily conversations across the variety of social media platforms and become a part of the Plaid community. Simply tag your comments and creations #PlaidCrafts.

Won't you join the fun and follow us today? Learn about the new products, try a new crafting technique, and become inspired by viewing our vast offering of easy-to-create artistic projects.



pinterest.com/plaidcrafts



plaidonline.com/blog



plaidonline.com



twitter.com/plaidcrafts



facebook.com/inspiredbyplaid



instagram.com/plaidcrafts



youtube.com/plaidcrafts
<http://bit.ly/MakeltWithModPodge>



plus.google.com/+PlaidOnline



modpodgerocksblog.com



Plaid's Mod Podge Rocks! blog and its creator, Amy Anderson, rock the creative world every day!

- Packed with creative content, phenomenal projects, titillating tips and tidbits
- 2014 Winner for Best Art, Craft or Design Weblog - Bloggies
- Featured on ABCNews.com, Huffington Post, iVillage, and more
- 6.2 million page views in a year, 175 thousand unique visitors each month
- 1.5 million fans/friends/followers

**For additional Mod Podge product information,
how-to videos and project inspiration, please visit:**

<http://plaidonline.com/modpodge>

CREATIVE CREDITS Plaid Enterprises Production Team: Category Director, Andrea Henfield; Brand Manager, Connie Lanham; Art Director, Paul LaPlaca; Graphic Designer, Jennifer Byerley; Hand Model, Anna Teal; Photography, John Armitage; and Education Content Curator, Chris Williams.